



Excellence by hardware and software design

A suit of devices focussed on examine the surface regularity requirements and assures the best combination of accuracy and precision

MODEL-T

Ready to verify slabs regularity

Maximum measurement accuracy

Led indicators and sound for easy monitoring of the process while using the equipment: synchronization, calibration and measurement.

Height adjustable mast.

Distance between wheels between 0,5 m up to 2,4 m.

Rechargeable battery (charger type C) for more than 48 hours working time.

Bluetooth low energy (BLE) communications.

Supported by a Software Platform specifically designed to simplify and guarantee the management of the measurement process:

- One single App for recording and access to measured data (IOS and AND). Automatic and configurable measurement every "x cm"
- Supervision and defined modes
- Specific configuration features for an easier use according to end user preferences.
- Multi language.
- Back-End cloud computing, 24x7 disponibility and accessibility. Allows project management in an easy and integrated way.
- Report and data export functionalities.

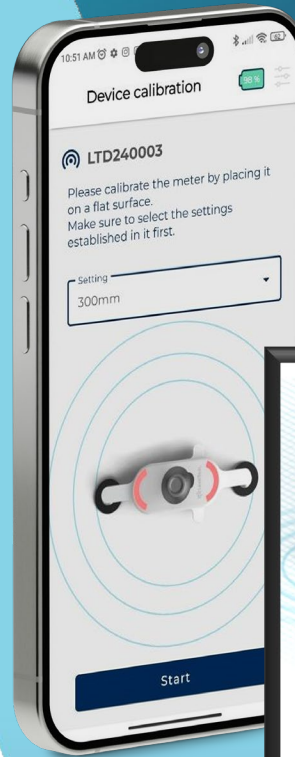

More info: <http://leveltech.pro>



Hardware technical features

Accuracy	$\pm 0,001^\circ$ o $\pm 3,6$ arcseconds	
Elevational	Spacing	0,5 m up to 2,4 m
	Height	0,005 in 0,005 mm
Thermal coupling	Working temperatures -40° to 80°	
High precision encoder	250 p/r	
Dimensions	Base	240 mm l x 60 mm w x 115 mm h
	Pole	650 to 1300 mm
Weight	3 kg	
Rechargeable Batteri Ion L	3350 mA, 24,12 wh, 48 h work time	

Hardware functional features

Configuration	Brightness
	Beep Sound
	Measurement frequency mm
Training mode	NA
Remote Firmware update	

Visual control of the process	Colour	Blinking
Equipment switch ON	Green	
Low battery level	Red	quick
Device without synchronisation with APP	Blue	slow
Synchronisation	Blue	quick
Calibration process 1st step	Orange	
Calibration process 2nd step completed	Blue	
Measuring process: value readed	Green	

(*) Back end for an easy integrated project management

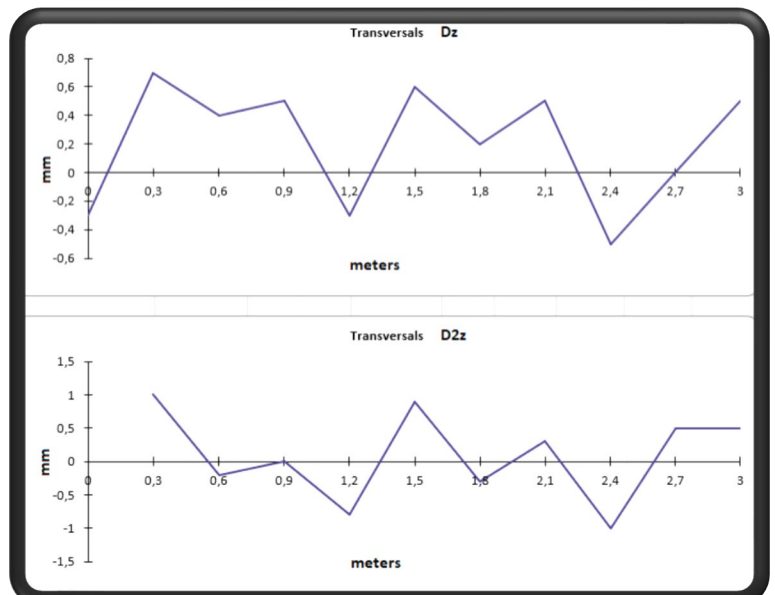

One single
APP for all
devices and
requirements (*)

